

MODEL #132BS BACKWARD SWINGUP

SPECIFICATIONS:

Backboard supporting main drop shall be in the form of a braced "T" of welded construction* where size will permit it to be so shipped. Braces shall be of at least 2 3/8" O.D. pipe and stem shall be 6 5/8" O.D. steel tube. Bracing shall extend to within 24" of top of backboard to assure adequate torsional support of the backboard. Backboard shall be extended at least 6 inches out from the drop by rigid support brackets.

An adequate-sized brace (at least 2-3/8" O.D. 9-ga) inclined 30 to 40 degrees from the vertical stem, shall support the stem to the rear of the backboard jackknife fold when tripped by tension on the hoist cable to allow raising of the backstop to a horizontal storage position, and lock straight in play position.

HOISTS

Each folding backstop shall be operated either by a No. K500 manual winch or a No. 75 electric operator complete with 1/4"-7x19 galv. aircraft cable, steel pulleys, and all anchors necessary to attain smooth, easy operation.

Pulleys shall have 3-1/2" O.D., deep grooved, solid steel sheaves turning on an oil-impregnated bronze bushing and hanging from a 360 degree swiveling clevis hanger. Support fittings shall have a ring of 5/8" dia steel rod.

All backstop parts, except as itemized below, shall be furnished in best grade (black enamel).

Optional colors available upon request.
Finish paint by section 9900.

Other items shall be finished as follows:

- Wood, fiberglass, and steel backboards; Glass backboards:** officially marked in white vitreous enamel;
- Goals:** two coats, powder coated orange enamel;
- Wood Stringers:** two coats of clear lacquer;
- Nuts & bolts:** zinc plated;
- Cable & chain:** galvanized.

OVERHEAD SUPPORTS

Suspension of ceiling-supported backstops shall be from spans of 3" SCH40 (3-1/2" O.D.) structural steel pipe, fastened to the roof framing with welded steel beam clamps and to masonry walls with steel fittings onto anchored wood pads of 2x8, #1 dense yellow pine. Spans exceeding 16' shall be of 6-5/8" O.D. x .188 wall steel tubing.

Compatible with any AALCO Backboard or Goal.

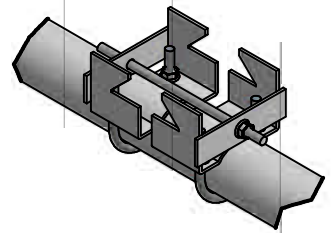

DETAIL A
K-15 BEAM CLAMP

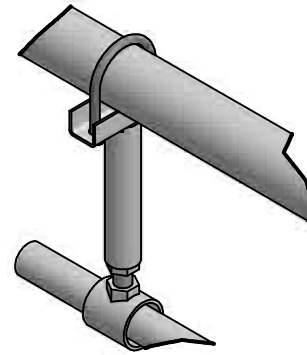

DETAIL B
K-12 EXT. HINGE

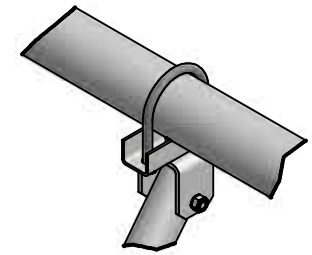

DETAIL C
K-81-U

#75 OPERATOR
(ON ELECTRIC UNITS)

3" X 2" 11-GA.
STEEL TUBING

*ALL WELDED
MAIN FRAME
6-5/8" O.D. 11GA. PIPE

SHOWN WITH
PROGUARD PADDING

RIM @ 10' A.F.F.

REQ'D: (#)

MODEL 132BS BACKWARD SWING UP

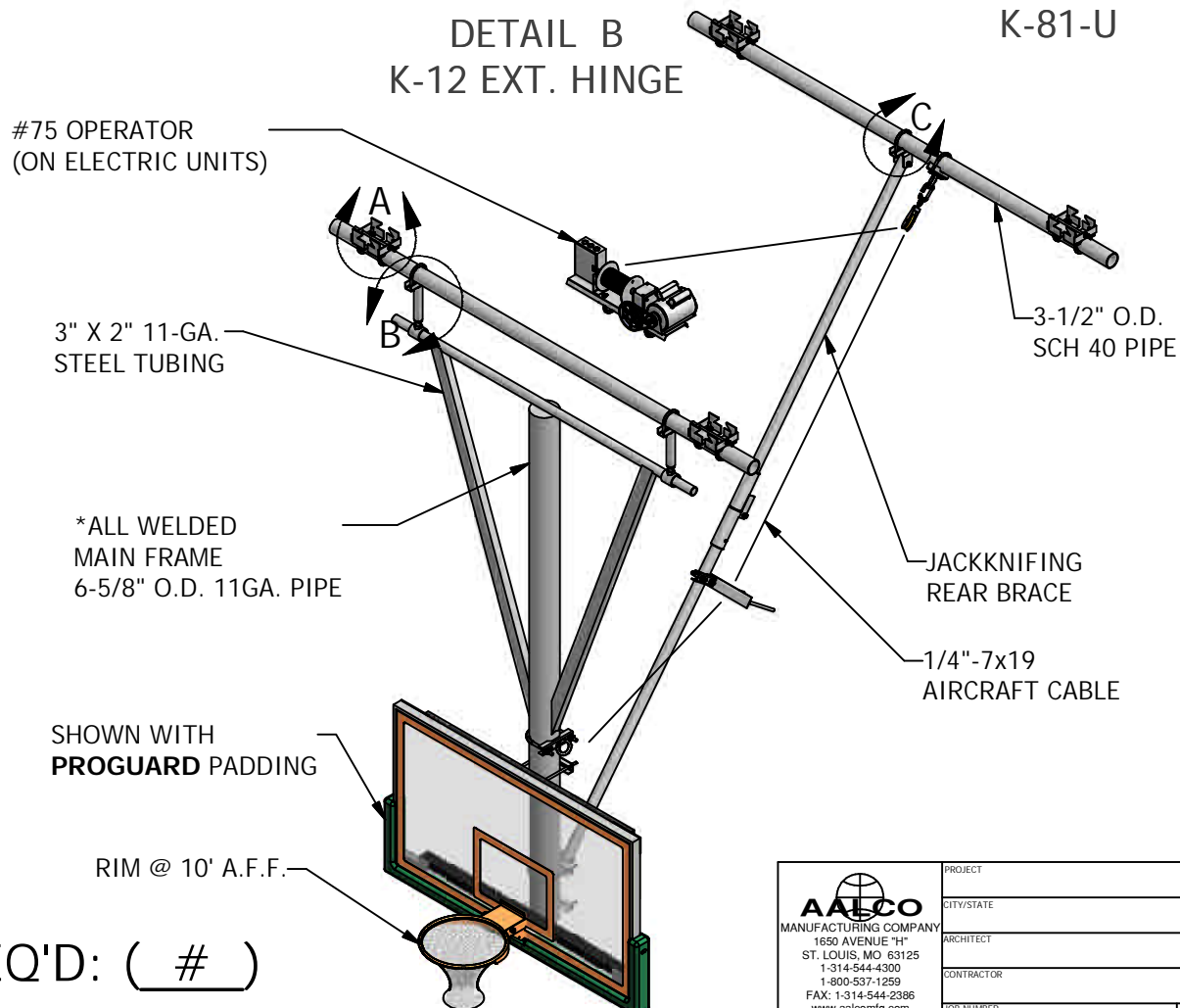

<p>AALCO MANUFACTURING COMPANY 1650 AVENUE "H" ST. LOUIS, MO 63125 1-314-544-4300 1-800-537-1259 FAX: 1-314-544-2386 www.aalcomfg.com</p>		PROJECT	
		CITY/STATE	
ARCHITECT		CONTRACTOR	
JOB NUMBER		DATE 10/2/2006	
REVISIONS	BY	SCALE NTS	DRAWN BY MLJ
		SHEET #	
SPEC SECTION 11480			